

RAINURE EXTENSIBLE

GROOVING AND REBBATING CUTTER - NUT UND FALZFRÄSER
 RANURAR Y GALCES - FRESE PER BATUTE

FRAISE LAMELLO

Lamello cutter head - Lamello-fräser - Fresas Lamello - Frese Lamello

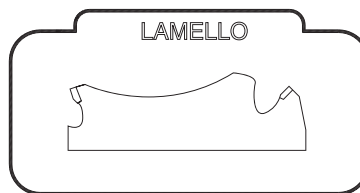

D mm	E mm	dmm	Z	Qualité	Code
100	3,97	22	6	HM	FRAI0001
100	3,97	22	12	HM	FRAI0002

FRAISES A RAINER EXTENSIBLES PAR BAGUES

Adjustable grooving cutter by spacing rings - Verstellnutfräser durch Ringe
 Fresa para ranurar extensible con anillos - Frese per incastri regolabili con anelli

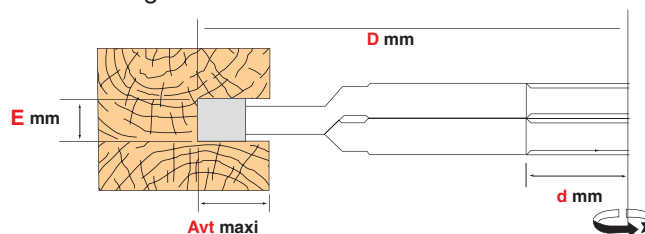

D mm	E mm	d mm	Avt	Z	Qualité	Code
140	4/7,5	50	20	4+4	HM	FRAI0003
140	5/9,8	50	20	4+4	HM	FRAI0004
140	10/20	50	20	4+4	HM	FRAI0005
160	5/10	50	25	4+4	HM	FRAI0256
160	10/20	50	20	4+4	HM	FRAI0508

PORTE-OUTILS A RAINER EXTENSIBLES PAR BAGUES

Adjustable grooving cutter by spacing rings - Verstellnutfräser durch Ringe
 Fresa para ranurar extensible con anillos - Frese per incastri regolabili con anelli



D mm	E mm	d mm	Avt	Z	Code
150	5/10	50	30	2(2+2)	FRAI108511
150	10	50	30	2	FRAI108512
160	4/7,5	50	35	2(2+2)	FRAI0009
160	5/9,5	50	35	2(2+2)	FRAI0010
160	10/20	50	35	2(2+2)	FRAI0011
160	8/16	50	35	2(2+2)	FRAI0350
160	10	50	35	2	FRAI0511
160	15/30	50	35	2(2+2)	FRAI0512

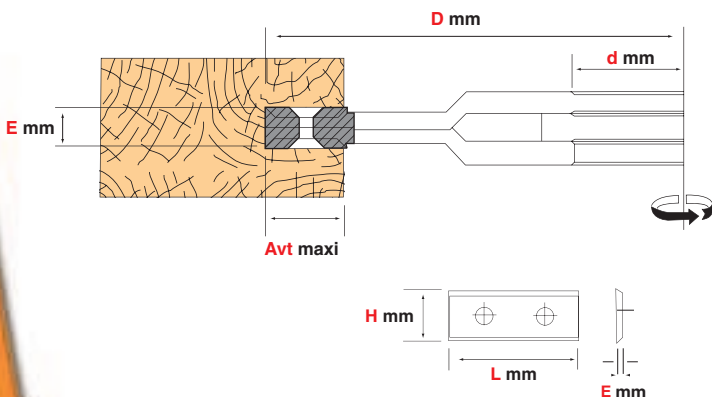

PLAQUETTE

Carbide Tips- HM-Plaketten - Plaqueta - Coltino

L mm	H mm	Emm	UC	UT	Code
7.6	12	1.5	10	1	PLAQ0067
9.6	12	1.5	10	1	PLAQ0066
14	1,4	1,2	10	1	PLAQ0049
14	14	2	10	1	PLAQ0068
15	12	1,5	10	1	PLAQ0051
18	18	1,95	10	1	PLAQ0062
18	18	2,5	10	1	PLAQ0105

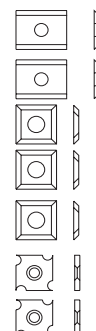

FEUILLURE ET ENFOURCHEMENT EXTENSIBLE

PROFILE-CUTTER AND CUTTERS HEAD - PROFILFRÄSER UND FRÄSKOPF
CABEZALES HORQUILLA EXTENSIBLE - FRESE E TESTE

PORTE-OUTILS A RAINER EXTENSIBLES PAR MOLETTE

Adjustable grooving cutter head - Verstellnutfräser - Cabezales para ranurar extensibles
Frese per incastri regolabili

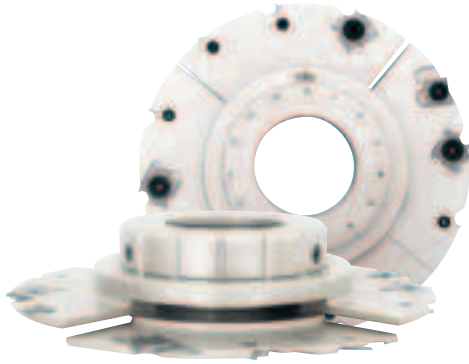

D mm	E mm	d mm	Z	Code
180	4/8	50	2x(2+2)	FRAI0568
180	8/16	50	2x(2+2)	FRAI0512

PORTE-OUTILS FEUILLURE EXTENSIBLES

Adjustable rabbeting cutter head - Verstellnut-Falz Fräser - Cabezal portacuchillos para juntas ajustables con anillo
Testa regolabile per battuta

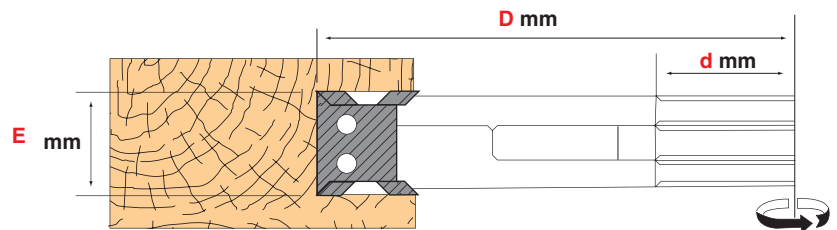

	D mm	E mm	d mm	Avt	Z	Code
<i>Corps alu.</i>	160	14/28	50		2(2+2)	FRAI0618
	160	15/30	50	45	2(2+2)	FRAI0012
	160	20/40	50	45	2(2+2)	FRAI0013
	160	30/60	50	45	2(2+2)	FRAI0500
<i>Corps alu.</i>	170	20/40	50		2(2+2)	FRAI0619
<i>Coupe biaise</i>	250	30/60	30		2(3+3)	FRAI0492
<i>Coupe biaise</i>	250	10/20	30		(2+2)	FRAI0491
<i>Coupe biaise</i>	250	30/60	50		2(3+3)	FRAI0486
	250	27,5/54,5	50		2(6+2)	FRAI0486HE

PLAQUETTE

Carbide Tips- HM-Plaketten - Plaqueta - Coltellino

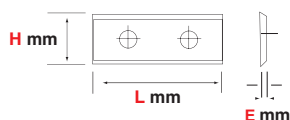

L mm	H mm	E mm	UC	UT	Code
14	14	2	10	1	PLAQ0068
15	12	1,5	10	1	PLAQ0051
20	12	1,5	10	1	PLAQ0053
30	12	1,5	10	1	PLAQ0054

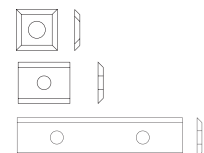

ENFOURCHEMENT EXTENSIBLE

PROFILE-CUTTER AND CUTTERS HEAD - PROFILFRÄSER UND FRÄSKOPF
CABEZALES HORQUILLA EXTENSIBLE - TESTE INCASTRO REGOLABILE

PORTE-OUTILS MULTI-TENONS

Multi-Tenonning cutter head - Messerkopf - Cabezal multi-tenon - Teste multi-tenone

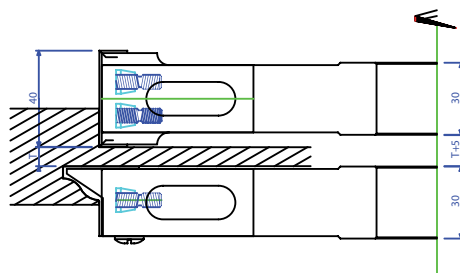

Cartouche H30
FRAI0659



Cartouche H40
FRAI0660

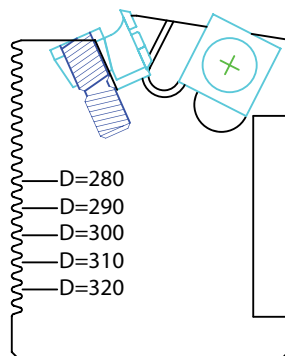

PO Multi-tenons

Code

FRAI0658

Cartouche a l'unité

Code

FRAI0659 H30

FRAI0660 H40

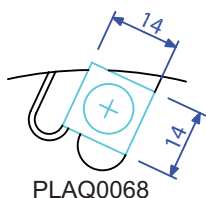

PLAQ0068

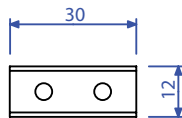

PLAQ0054

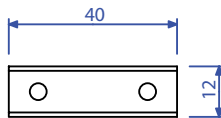

PLAQ0055

PLAQUETTE

Carbide Tips - HM-Plaketten - Plaqueta - Coltellino

L mm	H mm	E mm	UC	UT	Code
30	12	1,5	1	1	PLAQ0054
40	12	1,5	1	1	PLAQ0055
14	14	2	1	1	PLAQ0068

PO Multi-tenon comprenant 2 cartouches hauteur 30 réglables de Ø280 à 320, tous les 5 mm.
Travaillant dessus ou dessous grâce aux araseurs sur les 2 faces de la cartouche.
Sur ce porte-outils on a la possibilité de monter des cartouches tenons Hauteur 40
et des cartouches contre-profil.

PORTE-OUTILS TENON COUPE BIAISE

Tenonning cutter head - Messerkopf - Cabezal para espigar - Teste tenone taglio assiale



	D mm	E mm	d mm	Avt	Z	Code
Corps alu.	200	30	50	65	4(2+2)	FRAI0620
Corps alu.	230	30	50	80	4(2+2)	FRAI0621
Corps alu.	250	30	50	90	4(2+2)	FRAI0622
	250	30	50	92	3+3DUS	FRAI0024
	250	30	50	92	3+3DOS	FRAI0025
	280	30	50	106	3+3DUS	FRAI0026
	280	30	50	106	3+3DOS	FRAI0027
	300	30	50	117	3+3DUS	FRAI0028
	300	30	50	117	3+3DOS	FRAI0029
	320	30	50	125	3+3DUS	FRAI0030
	320	30	50	127	3+3DOS	FRAI0031

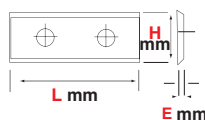
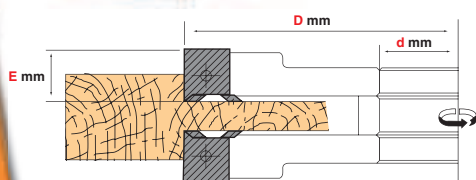

PLAQUETTE - Carbide Tips

HM-Plaketten - Plaqueta - Coltellino

L mm	H mm	E mm	UC	UT	Code
14	14	2,0	10	1	PLAQ0068
30	12	1,5	10	1	PLAQ0054

ENFOURCHEMENT, MULTI-FONCTIONS

MULTI-PROFILE AND PLANING CUTTER HEAD - MULTI-PROFIL UND HOBEL MESSERKOPF
CABEZAL PARA CEPILLAR O CANTEAR MULTI-PERFILES - PIALLA, MULTI USO

PORTE-OUTILS ENFOURCHEMENT EXTENSIBLE

Adjustable Slotting Cutter Head - Wendepalten-Vorschneid-Nutfräser
Cabezal Horquilla Extensible - Teste regolabile multi uso

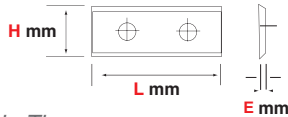
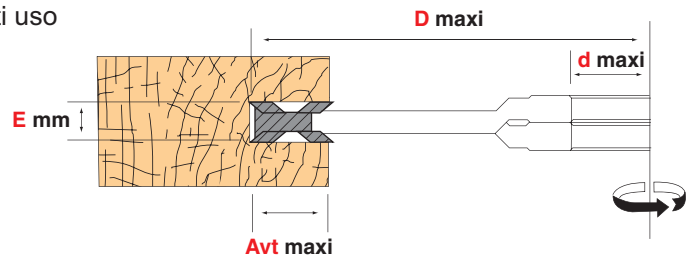

PLAQUETTE - Carbide Tips

HM-Plaketten - Plaqueta - Coltellino

L mm	H mm	E mm	UC	UT	Code	PRIX
14	14	2,0	10	1	PLAQ0068	2,87
7,6	12	1,5	10	1	PLAQ0067	3,41
9,6	12	1,5	10	1	PLAQ0066	2,86
15	12	1,5	10	1	PLAQ0051	2,49

D mm	E mm	d mm	Avt	Z	Code
178	8	50		2(2+2)	FRAI0623
184	8	50		2(2+2)	FRAI0624
250	8/16	50	45	2(3+3)	FRAI0032
250	12/24	50	45	2(3+3)	FRAI0033
250	15/30	50	45	2(3+3)	FRAI0034
300	8/15,5	50	65	2(3+3)	FRAI0035
300	10/20	50	65	2(3+3)	FRAI0036
300	15/30	50	65	2(3+3)	FRAI0037
320	8/15,5	50	75	2(3+3)	FRAI0038
320	10/20	50	75	2(3+3)	FRAI0039
320	15/30	50	75	2(3+3)	FRAI0040

PORTE-OUTILS A CALIBRER

Helical Cutter Head - Kalibrier-Fräskopf - Porta Cuchillas - Testa elicoidale con coltelli



D mm	H mm	d mm	Z	Code
80	80	50	12	FRAI0485
80	120	50	18	FRAI0488

PLAQUETTE

Carbide Tips - HM-Plaketten - Plaqueta - Coltellino

L mm	H mm	E mm	UC	UT	Code
14	14	2,0	10	1	PLAQ0068

Livré avec roulement
Pound With Bearing
Mit Lager Geliefert
Libra cojinete de bolas
Libbra cuscinetto

